



Must Do Configuration To See Expected Tracking Results

For every employee here is the checklist to ensure correct travelled distance calculated by the system, failing to strictly follow these guidelines will cause poor tracking results and hence incorrect distance travelled. Any violation of these guidelines will be captured with time and location for the supervisor to review.

1. Employees needs to **Log in** to the **Mgm Neeuma Man Up Care** app before the trip starts and **Log out** when the trip ends (single/multi-day trip).
2. Every working day employee must punch **Attendance** in the morning to declare start the of the day and punch **Attendance** in the evening to declare the end of the day.
3. Employee must not **Power Off** the phone and switch off **Location** or **Log out** from the App when the trip is on.
4. When the trip is on, the **Power Saver Mode** or the **Airplane mode** of the phone must be off, otherwise to save power phone internally may switch off location service from time to time.
5. Employee must keep checking the phone's permanent notification for **Mgm Neeuma Man Up Care & Monitor Man Up Care** app and if these 2 notifications are not visible it means the background service is killed by phone and by fixing phone configuration (**as suggested below for different phone models**) can only protect the background service.
6. Employees have an option in the **Mgm Neeuma Man Up Care** app to monitor their own tracking and if their tracking is not coming properly for the route they followed then they must immediately report it with the support team.

7. At the time of Apps installation if Apps Auto Start is not enabled then it needs to be enabled by opening the **Mgm Neeuma Man Up Care app -> Manage Task ->.Top Right Corner(3 dots) -> Enable Auto Start** and enable **Auto Start** for **Mgm Neeuma Man Up Care** and **Monitor man up care** app where **Enable Auto Start** option is available.

8. Till the time the tracking is not getting stabilized for most of the employees previous day report(and don't wait for month-end report) of total distance travelled should be shared with all concerned parties so that early detection of a problem can happen.

For MI Phones

Every MI phone has a Security App as shown in the picture below. Open it and navigate as below

Security App > Battery > App Battery Saver

App list will appear and tap " Mgm Neeuma Man Up Care " and "Monitor Man Up Care" Apps one by one then select "No restriction" mode.

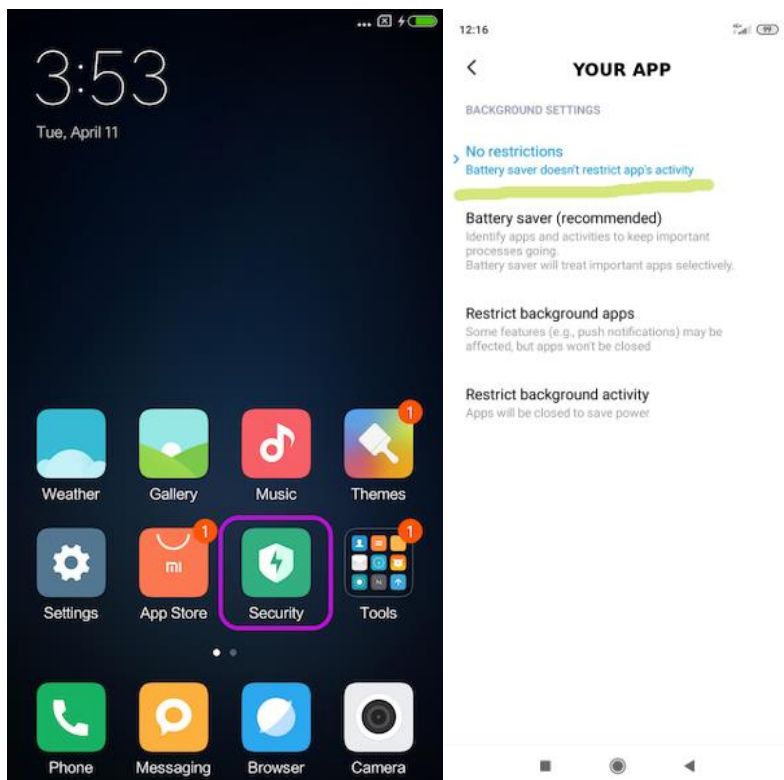

For Vivo Phones

1. Go to Phone Settings > Battery.
2. Go to High background power consumption.
3. Find Mgm Neeuma Man Up Care and Monitor man up care in the list and enable these for high battery consumption. For Vivo phones, any app running in the background is categorized as high battery consumption even if it is running with zero battery consumption.

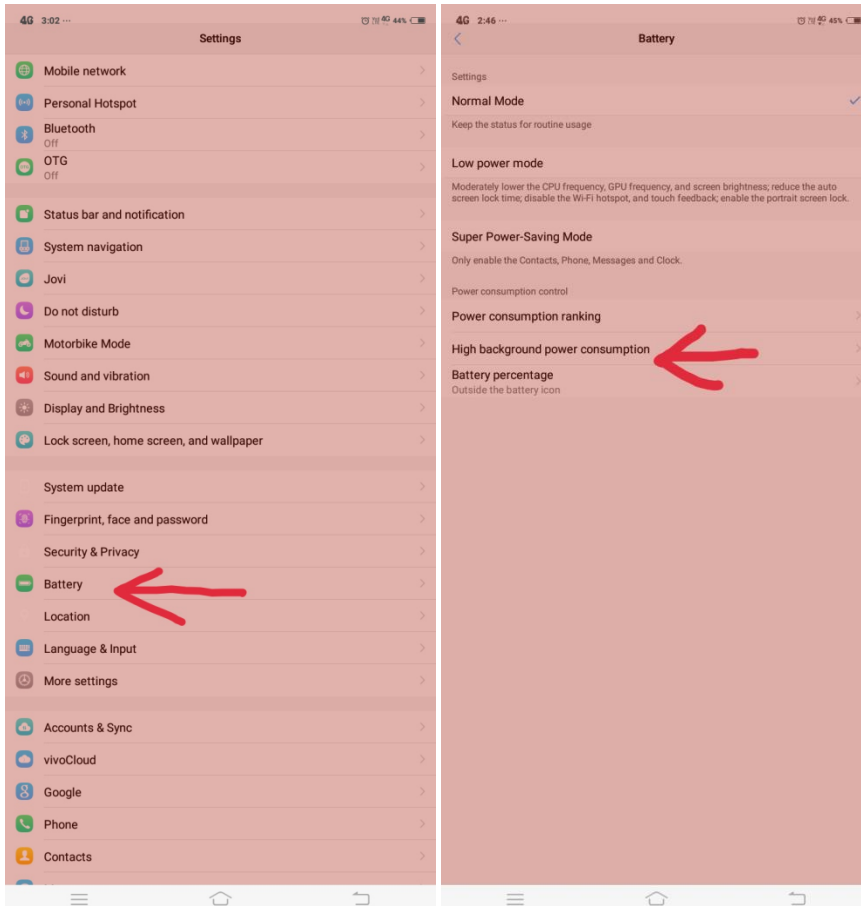

For Huawei & Honor Phones

Phone settings > Battery > App launch and then set both " Mgm Neeuma Man Up Care " and "Monitor Man Up Care" apps to "Manage manually" by disabling the toggle button.

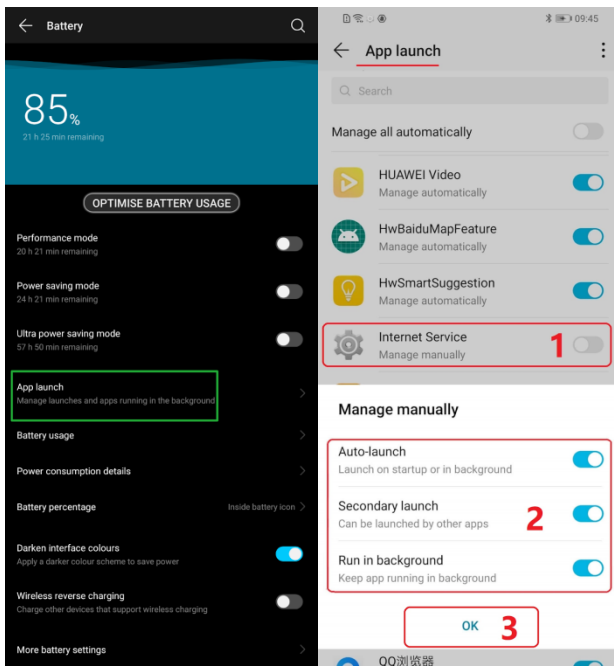

For Older OPPO Phones

Find Mgm Neeuma Man Up Care and Monitor Man Up Care apps in the list and disable options in the apps as mentioned in step 5 below.

